

3360 Emerald Ridge

3 Bedroom Ranch Condo

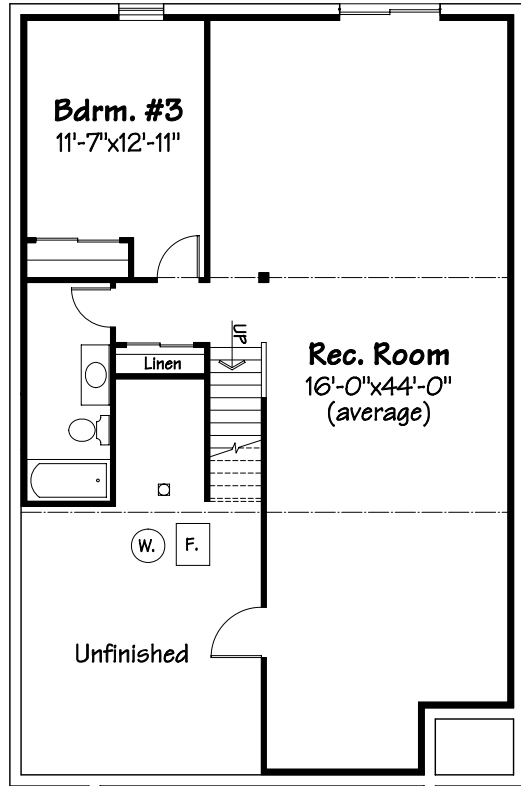

LOWER LEVEL
1,009 sq. ft.
(finished)

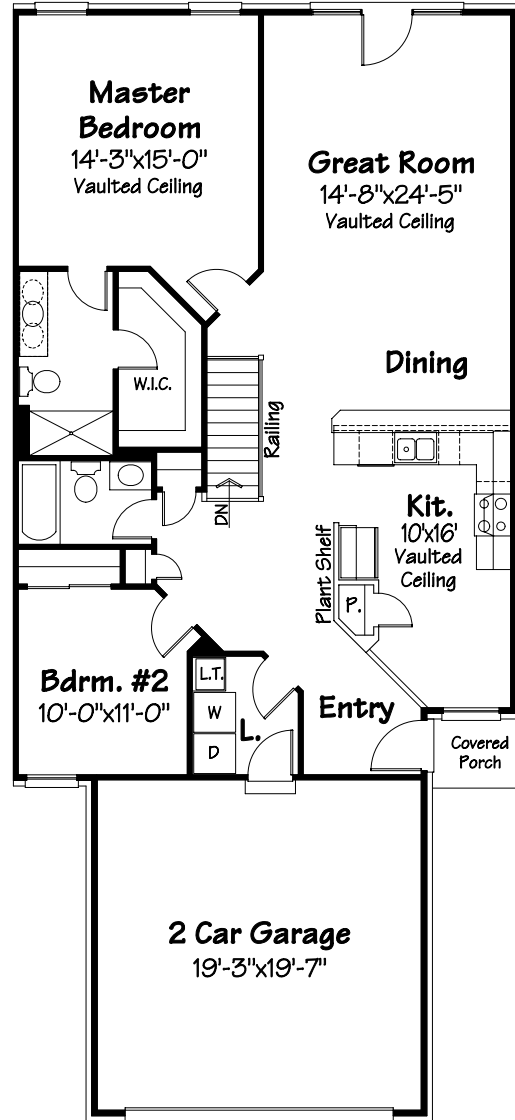

FIRST FLOOR
1,350 sq. ft.

Features:

- Finished lower level w/ Third Bedroom, full bath and Rec Room
- Dramatic open floor plan w/ vaulted ceilings.
- Over 2,350 square feet of living space.
- Elegantly detailed elevation.
- 2 Bedrooms & 2 full baths on first floor.
- Owners suite w/ large walk-in closet
- Two car attached Garage.
- Kitchen includes: Smooth-top Range, Microwave, & Dishwasher
- Covered front entry.
- Convenient first floor laundry.
- Covered wood deck.

Craftsmanship with Service

MEIERJOHAN



662-3111

Meierjohanbuildinggroup.com

This brochure is for illustrative purposes only. All floor plans, exterior renderings and dimensions are approximate, not drawn to scale and are subject to change. Floor plans, exterior and standard features may vary per community and per elevation and options selected. Please see your sales representative for specific details. Meierjohan Building Group reserves the right to modify all plans, specifications & pricing without notice or obligation. This brochure is not part of a legal contract. Copyright 2011 Meierjohan Building Group. All rights reserved.

Revised - 10/21/11